

## BRP Can-Am / Maverick X3

**Part No.:** 2444.7246.1 Front bumper incl. Winch mount plate  
**Brand:** BRP Can-Am  
**Model:** SSV Maverick X3, X3 MAX  
**Year:** 2017-  
**Material:** Tube Al 38x3 mm



### Content

1. Bumper.....	1 pc.
2. Left side tube.....	1 pc.
3. Rear side tube.....	1 pc.
4. Winch mounting plate.....	1 pc.
5. Front protection plate.....	1 pc.
6. Insert nut M6.....	2 pc.
7. Screw M6x16.....	2 pc.
8. Screw M8x25.....	8 pc.
9. Nut M8.....	2 pc.
10. Washer 6.....	2 pc.
11. Washer 8.....	10 pc.

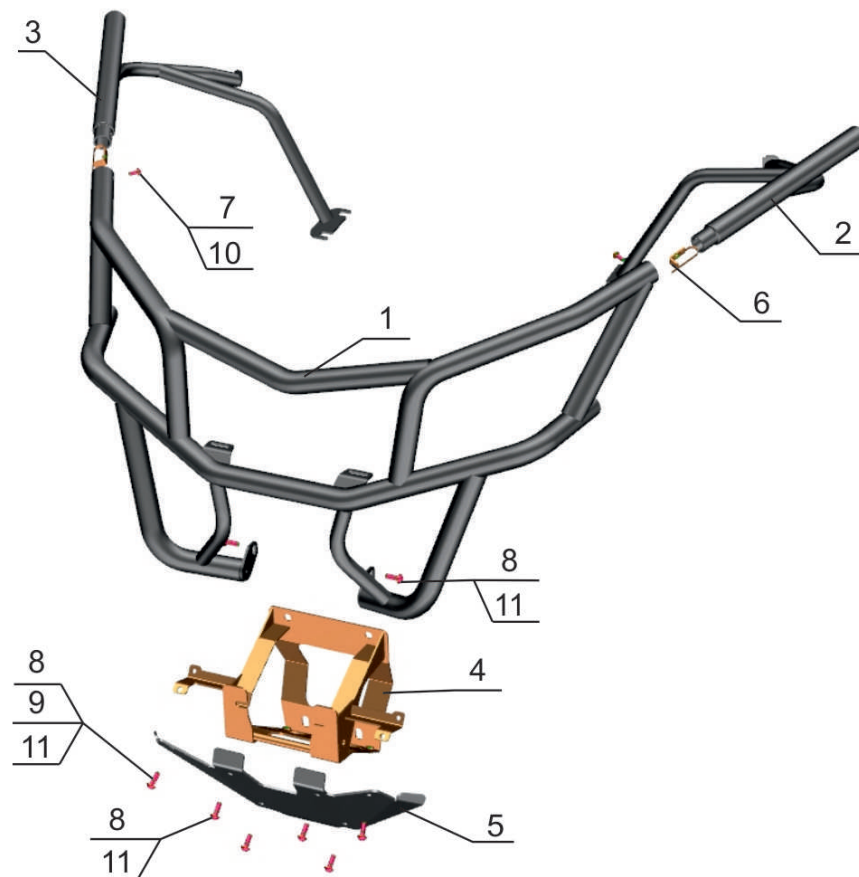
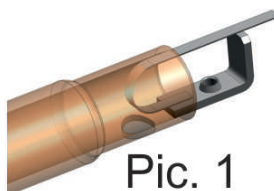

### Installation Instructions

1. Remove front plastic panel with lights as shown on pic. 2. Unscrew the bolts which fix radiator (pic.3). Unscrew the nuts from suspension arms and then remove the original tube bumper.
2. Install winch mounting plate no.4 at the same place instead of original tube bumper and then torque the nuts of suspension arms. Remove the cage nuts from original tube bumper (pic. 3) and then mount them to the similar holes of winch mounting plate. Fix the radiator. Mount back the front plastic panel with lights.
3. Unscrew the bolts of front stabilizer. Fix the lower brackets of side tubes no.2, no.3 to original fitting points of stabilizer using the original bolts.
4. Install insert nuts no.6 into the side tubes as shown on pic. 1.
5. Mount the bumper on the vehicle. Fix upper tubes of the bumper to the side tubes using screws M6x16 no.7, washers 6 no.10. Fix lower part of the bumper to winch mounting plate using screws M8x25 no. 8, washers 8 no.11.
6. Fix plate no.5 to winch mounting plate using screws M8x25 no.8, washers 8 no.11, and from sides using screws M8x25 no.8, washers 8 no.11, nuts M8.
7. Tighten all screws.

#### TOOLS REQUIRED

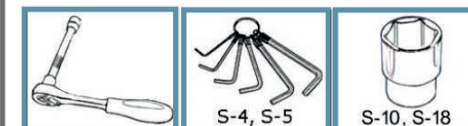

#### SCREW FORCE



## Attachment



Pic. 2

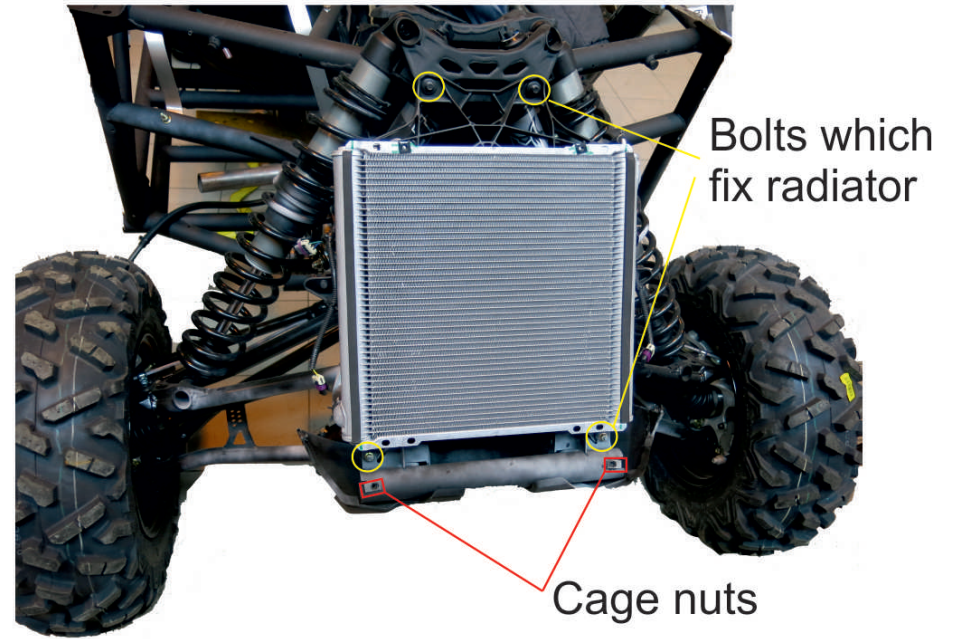

Pic. 3